

MAGIC CIRCUIT

⚠ WARNING:
CHOKING HAZARD - small parts.
Not for Children under 3 years.

TO PARENTS: PLEASE READ THROUGH THESE INSTRUCTIONS
BEFORE GIVING GUIDANCE TO YOUR CHILDREN.

PLEASE SCAN THE QR CODE FOR VIEWING MULTI-LANGUAGE INSTRUCTIONS.



FR. Veuillez scanner le code QR pour afficher les instructions multilingues pour ce kit. DE. Bitte scanne den QR-Code, um die mehrsprachige Anleitung für dieses Set anzusehen. NL. Scan de QR-code om de instructies voor deze set in verschillende talen te bekijken. IT. Scansiona il codice QR per visualizzare le istruzioni multi-lingua per questo kit. ES. Escanee el código QR para ver instrucciones en varios idiomas para este kit. JA. QRコードをスキャンして、本キットの多言語説明書をご覧ください。

A. Safety Messages

1. Adult assistance and supervision are required at all times. 2. This kit is intended for children over 5 years of age. 3. This kit and its finished product contain small parts which may cause choking if misused. Keep away from children under 3 years old. 4. To prevent possible short circuits, never touch the contacts inside the battery case with any metal objects. 5. Only install batteries after you have assembled the product. Adult supervision is required.

B. Use of Batteries

1. Requires two 1.5 V AAA batteries (not included). 2. For best results, always use fresh batteries. 3. Make sure you insert the batteries with the correct polarity. 4. Remove the batteries from the kit when not in use. 5. Replace exhausted batteries straight away to avoid possible damage to the kit. 6. Rechargeable batteries must be removed from the kit before recharging. 7. Rechargeable batteries must be recharged under adult supervision. 8. Make sure the supply terminals in the battery case are not short circuited. 9. Do not attempt to recharge non-rechargeable batteries. 10. Do not mix old and new batteries. 11. Do not mix alkaline, standard (carbon-zinc), or rechargeable batteries. 12. Unscrew the battery case to replace the batteries. Adult supervision is required.

Insert 2 x 1.5V AAA batteries into the circuit module as shown in the diagram. Make sure the batteries are inserted in the correct direction (the flat end of the battery always goes against the spring). Adult supervision is required.

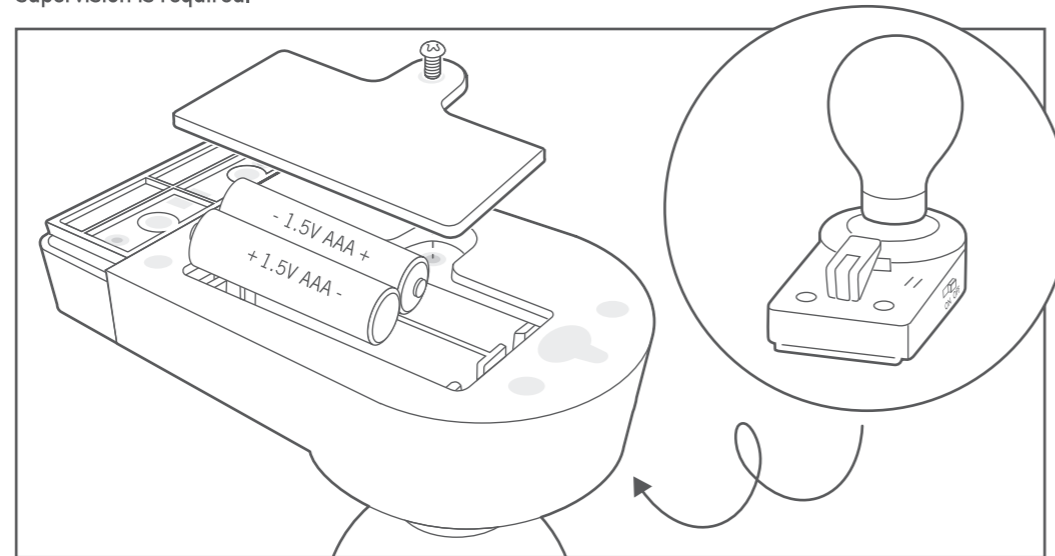

C. Contents:

Part A: 1 magic circuit module (MCM), Part B: 9 game cards, Part C: 1 game template, Part D: 1 conductive tape, Part E: 1 foil sheet, Part F: 1 pencil, Part G: 1 tweezers, Part H: 2 terminal caps, Part I: 2 wires with rings, Part J: 2 joint pieces sets, Part K: 2 checker holders, Part L: 1 wire set (wand & wire), Part M: 1 wand holder set, Part N: 1 dice, Part O: 1 double-sided adhesive tab, Part P: 1 adhesive tab. Contents are for making 6 fun circuit games. Assembling and game instructions are printed on the respective game cards. (Also required but not included in the kit: 2 x 1.5V AAA batteries, a small crosshead screwdriver.)

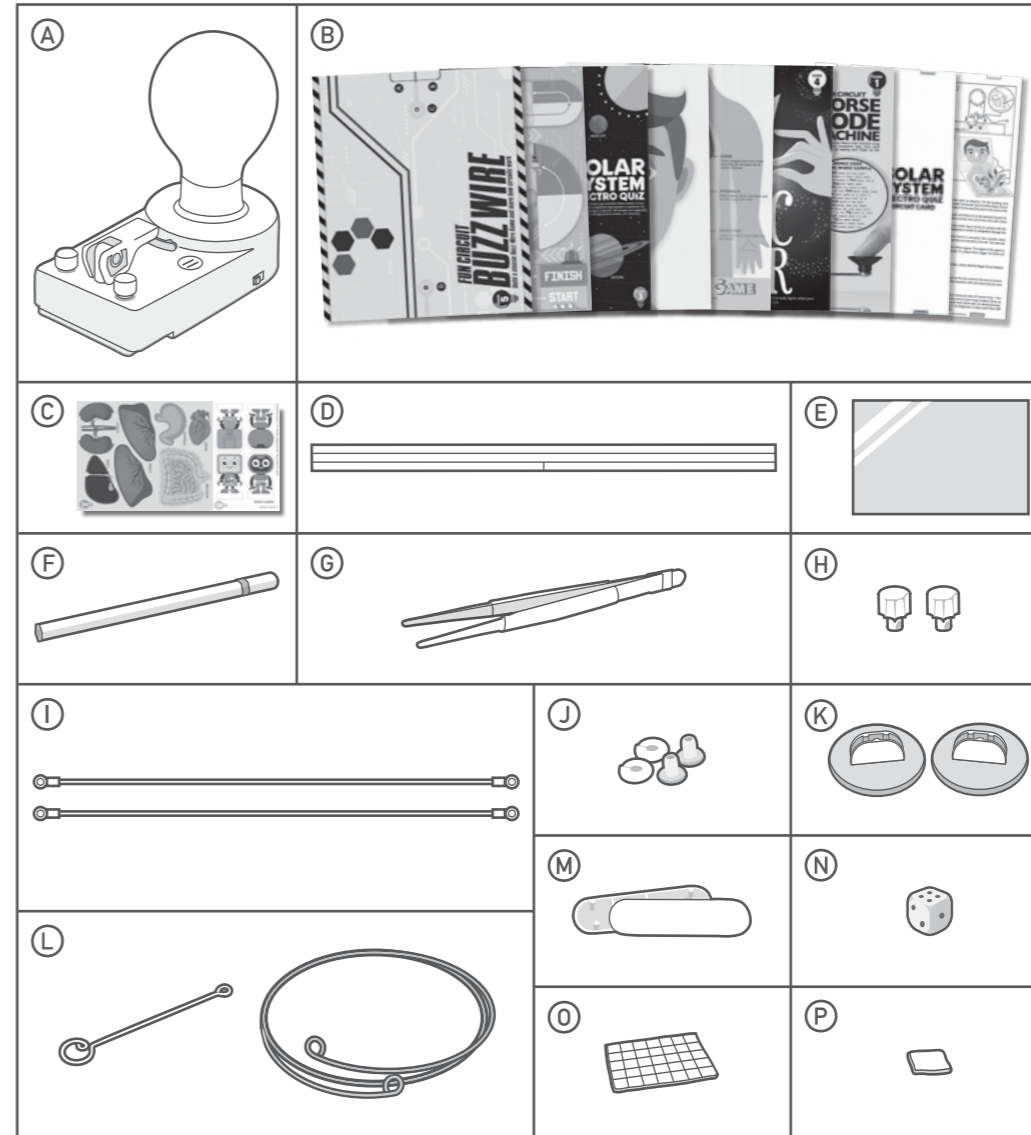

QUESTIONS & COMMENTS

We treasure you as a customer and your satisfaction with this product is important to us. In case you have any comments or questions, or you find any parts of this kit missing or defective, please do not hesitate to contact our distributor in your country, whose address is printed on the package. You are also welcome to contact our marketing support team at Email: infodesk@4M-IND.com. Fax (852) 25911566, Tel (852) 28936241. Web site: WWW.4M-IND.COM